

Technical specifications

- Available in PN10/16/25/40.
- Angular deflection +/- 6°.
- Resicoat RT9000 R4 Epoxy coated (blue Ral 5015).

For Ductile Iron pipe

DN	Size O.D.	Art. No.	L mm	D mm	Weight kg
500	532,0	C0160532F0000	235	627	28,5
600	635,0	C0160635F0000	235	730	34,0
700	738,0	C0160738F0000	230	838	48,9
800	842,0	C0160842F0000	230	942	54,9
900	945,0	C0160945F0000	230	1045	65,2
1000	1048,0	C0161048F0000	245	1161	73,7
1100	1152,0	C0161152F0000	245	1265	80,2
1200	1255,0	C0161255F0000	260	1368	87,3
1400	1462,0	C0161462F0000	260	1593	177,8
1500	1565,0	C0161565F0000	260	1696	189,4
1600	1668,0	C0161668F0000	260	1799	201,1

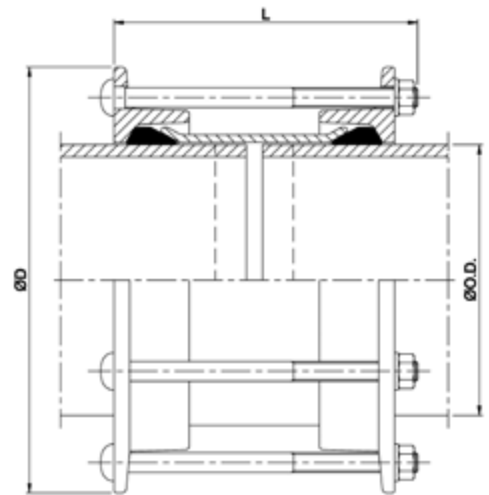

For steel pipe

DN	Size O.D.	Art. No.	L mm	D mm	Weight kg
500	508,0	C0160508F0000	235	603	27,4
600	609,6	C0160610F0000	235	705	32,7
700	711,2	C0160711F0000	230	811	47,3
800	812,8	C0160812F0000	230	913	53,2
900	914,4	C0160914F0000	230	1014	59,9
1000	1016,0	C0161016F0000	245	1129	70,9
1100	1118,0	C0161118F0000	245	1231	78,1
1200	1220,0	C0161220F0000	245	1333	85,2
1400	1420,0	C0161420F0000	260	1551	173,1
1500	1520,0	C0161520F0000	260	1651	186,1
1600	1620,0	C0161620F0000	260	1751	195,6

COMPONENTS

	Description	Material	Coating
1	Body	S235JR EN10025	EPOXY RAL-5015
2	End ring	S275JR EN10025	EPOXY RAL-5015
3	Bolts	Steel	Hot dip galvanised
4	Rubber gaskets	EPDM	

Bigger and different sizes on request.